



Chalet Panorama Selva Val Gardena, Dolomites



What we love...

We love the luxury shared spa, complete with indoor/outdoor swimming pool, Finnish sauna, outdoor Jacuzzi, ice fountain and Hammam.

A contemporary luxury ski apartment that combines traditional charm with mod cons, Chalet Panorama is part of the beautiful Chalet Val Gardena; three boutique chalets that are situated within the Hotel Rodella.

You'll find you can enjoy the best of everything here. The apartment offers all the comforts and privacy of any luxury ski chalet, yet you have all the amenities offered by a boutique ski hotel right on your doorstep.

First, there's the wonderful shared spa with its indoor/outdoor heated swimming pool, outdoor Jacuzzi, Finnish sauna, ice fountain, Hammam and relaxation area, where you can kick back after a hard day on the slopes and let your body be gently restored to full relaxation. There's also a shared ski and boot room, which means you can be measured up for your

ski gear as soon as you arrive and when you get in from the mountains each afternoon, you can simply kick off your wet boots and clothes and get on with enjoying your holiday.

The apartment itself has a lovely living space, which is perfect for gathering in with friends and family for a cosy drinks party or simply to catch up with your group. The living spaces are light and contemporary, decorated in a neutral palette using warm woods and natural stone; the ideal backdrop for a laid-back holiday, and the perfect spot for relaxed drinks while you and your party catch up on all the day's adventures.

Before you retire to your cosy bedrooms, do take a drink out onto the balcony to enjoy the mountain views and fresh air, and just drink in that peaceful atmosphere before you head off for a night of deep and restful sleep.



Chalet Panorama

Rooms

Chalet Panorama sleeps 5 guests in three bedrooms.

Bedroom 1:
Double/twin bedroom with en-suite shower room and balcony access.

Bedroom 2:
Double/twin bedroom with en-suite shower room.

Bedroom 3:
Single bedroom with en-suite shower room.

Eating

Food and drink are one of the cornerstones of life at Chalet Panorama and with that in mind, on your arrival, Prosecco and canapés will be waiting for you with a welcome reception.

Each morning, a buffet breakfast and selected hot dishes are served to set you up for a day on the slopes. And when you return, an afternoon tea of sweet or savoury treats will be laid out ready for you.

A four-course dinner is offered on six evenings and orders are taken each morning for that evening. There's an antipasto course, then a choice of two pasta or soup dishes, three main courses and a selection of delicious desserts to pick from. Your chef prepares all the food on the floor below the chalet, and your dedicated butler serves you in the privacy of your own apartment. Please note that drinks will be charged for separately.

A kitchenette is well equipped so you can make yourself tea and coffee or snacks whenever you wish. On your chef's night off, you can eat in the Hotel Rodella's dining room or your concierge will be happy to help with restaurant bookings, too. We particularly like the Michelin-starred AlpenRoyal Gourmet restaurant in Selva Gardena.

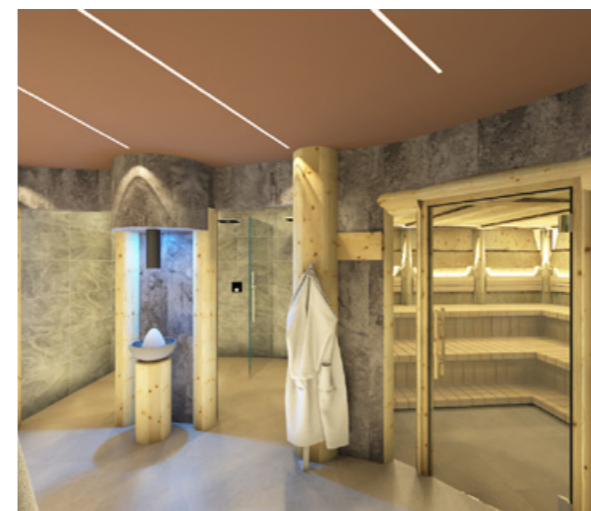



Chalet Panorama

Kids

Children are given a warm welcome at Chalet Panorama and there is a cosy single bedroom that would be perfect for a child here.

After a busy morning at ski school, younger visitors are sure to enjoy splashing in the hotel's indoor/outdoor swimming pool in the shared spa and wellness area.

The hotel staff will do all they can to ensure your family break goes without a single hitch, whether that's arranging skiing lessons or sorting outdoor activities to keep everyone entertained.

Nannies and babysitters can be arranged on request.

Staff

Firefly pre-arrival concierge service

Chalet staff include:
Butler
Daily housekeeping
In-resort shuttle service
In-resort concierge service

Additional staff such as nannies and massage therapists can be arranged on request.

Location

Chalet Panorama is located just a 3 mins drive from the Col Raiser cable car, 4 mins to Ciampinoi lift and 6 mins from the Danterceppies cable car station, so a wealth of skiing is right on your doorstep.

The village of Selva itself is a 3 minute drive or a 20 minute walk away, and a shuttle service is available each day to whisk you wherever you want to go in the resort.

The nearest airport is Innsbruck, approximately 1 hour 40 mins away.

Facilities

Open-plan living area
Kitchenette
Balcony
Village and mountain views
Wifi

Access to shared spa facilities with:
Indoor/outdoor swimming pool
Outdoor hot tub
Hammam
Finnish sauna
Ice fountain
Relaxation area
Massage and beauty treatment area

